

WHAT TO EXPECT WHEN YOU COME TO THE CLINIC

Before you come:

The referrals team will ask you simple questions to enable registration with the clinic and to provide some background for the consultant.

You will be able to choose when you come in and who you wish to see. The referrals team will guide you through the options.

The booking will be passed on to the consultant who may ask you to come to the hospital in advance of the consultation for some tests. The referrals team will organise and schedule this with you.

You will be asked to provide information in relation to funding of your treatment, whether through insurance authorisation details or request for payment before any tests are carried out. The referrals team will be able to provide a rough estimate of the costs before you commit.

On arrival:

Please make your way to the Lyndhurst Private Outpatient Consulting Rooms on the 1st floor of the hospital. Please ensure that you arrive 15 minutes before your scheduled appointment.

On completion of the appointment:

You may be required to finalise payments if there are any funding arrangements to complete. The Private Patients team will follow up with you later if there are any further follow up appointments required. You will receive your medical report directly from the consultant.

AT THE ROYAL FREE LONDON PRIVATE OPHTHALMOLOGY CLINIC

Where to find us?

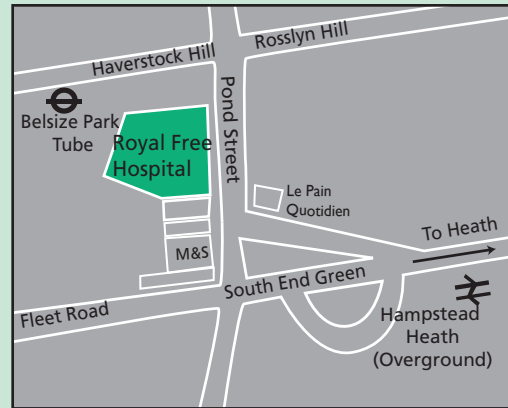

Royal Free London
Private Patients Unit
First Floor –
Lyndhurst Rooms
Pond Street
London
NW3 2QG

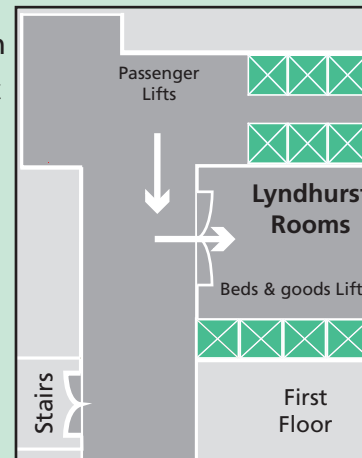

CONTACT THE RFL PPU REFERRALS TEAM TO BOOK AN APPOINTMENT

Direct Dial Number: +44(0)2073177751

E-mail: rfl.privateenquiries@nhs.net

Fax: 02078302089

Website: www.royalfreeprivatepatients.com –
Please fill out the online enquiry form



Royal Free London Private Ophthalmology Clinic

At the Royal Free London Private Ophthalmology Clinic, our Ophthalmologists see, diagnose and treat all problems that occur within two centimetres of the pupil. This includes all red and painful eye problems, visual problems, double vision and squint problems, children's eye services, eyelid problems, neurological eye problems and trauma.

Inpatient admissions and theatre facilities are also available at the Royal Free London Private Patients Unit.

We have specialists at the Royal Free London Private Patients Unit in the following areas:

- **Cataract Surgery** - Mr Hugo Henderson, Miss Clare Davey, Miss Susanne Althausen, Mr Riaz Asaria and Miss Bola Odufuwa.
- **Age Related Macular Degeneration** - Mr Riaz Asaria and Miss Clare Davey
- **Oculoplastic, Orbital and Lacrimal Surgery** - Mr Hugo Henderson
- **Diabetic Eye Disease** - Miss Clare Davey and Mr Riaz Asaria
- **External Eye Disease** - Miss Jenny Forbes
- **Paediatrics** - Mr Saurabh Jain
- **Neuroophthalmology** - Dr Desmond Kidd
- **Glaucoma** - Miss Bola Odufuwa
- **Medical Eye Diseases** - Miss Clare Davey
- **Vitreoretinal Surgery** - Mr Riaz Asaria

THE TEAM

Mr Hugo Henderson MA MB BS FRCOphth
Consultant Ophthalmologist and Oculoplastic Surgeon

Special interests:

Oculoplastic surgery, lacrimal surgery and cataract surgery

Mr Riaz Asaria BM MD FRCOphth
Consultant Ophthalmologist and Vitreoretinal Surgeon

Special interests:

Cataract surgery, medical and surgical retina, treatment of age related macular degeneration and trauma

Miss Jennifer Forbes MB BS Bsc FRCS (Ophth) (Glasgow)
FRCOphth

Consultant Ophthalmologist

Special interests:

General ophthalmology, cataract surgery, ocular surface

Mr Saurabh Jain MBBS MS FRCOphth
Consultant Ophthalmic Surgeon

Special interests:

General ophthalmology, paediatric ophthalmology and strabismus, cataract surgery

Miss Clare Davey MBBS FRCOphth

Special interests:

General ophthalmology, medical retina, cataract surgery, diabetic retinopathy

Miss Bola Odufuwa MBBS DO FRCOphth FRCS (Ed) MSc

Special interests:

General ophthalmology, cataract surgery, glaucoma, paediatric ophthalmology, squint surgery

Dr Desmond Kidd MD FRCP

Consultant Neurologist

Special interests:

Neuro-ophthalmology, sarcoidosis, Behçet's syndrome and other are inflammatory diseases

Miss Susanne Althausen FRCSEd, FRCOphth, MD
Director of the NCL Diabetic Eye Screening Programme

Special interests:

Diabetic retinopathy, cataract surgery

Available Services:

- Eye Condition Diagnosis (general Ophthalmology concerns)
- Diabetic Eye Disease Service
- Glaucoma Assessment
- Inflammatory Eye Assessment
- Cataract Service
- Squint Service
- Treatment of Watery Eyes
- Eyelid Surgery
- Ophthalmic Assessment
- Fluorescein Angiography
- Optical Coherence Tomography
- Optical Disc Imaging
- Minor Operational Service

The Clinic is available on same day booking basis Wednesdays and Thursdays from 5:30pm to 8:00pm

PAYMENT

We are recognised by all major UK health insurers. Please ensure that you have spoken to your insurer and obtained authorisation for your treatment prior to your consultation or treatment. Please bring your authorisation reference with you.

If you do not have private medical insurance, or you cannot obtain cover for this treatment, you will be requested to pay for your consultation or treatment before you visit. Call us for guidance on how much your treatment may cost.